



the BottleYard  
STUDIOS

Our space, your creativity. **It's all here.**

# WELCOME TO THE BOTTLE YARD STUDIOS

## NETFLIX



## STARZ

## MASTERPIECE



Sid Wild

Films Ltd.



## Clerkenwell FILMS



LOOKOUT  
POINT

## MAMMOTH SCREEN



company pictures

NEW PICTURES

## KUDOS



## THE FORGE



## WORLD PRODUCTIONS

**The largest film and TV studio in the West of England**

Located in Bristol, an internationally recognised UNESCO City of Film, The Bottle Yard is at the heart of a thriving TV and film industry in one of the UK's most creative, film-friendly cities.

**We have the space for your next screen creation.**

11 BAFTA albert-accredited stages are available for hire; eight at our original site TBY1 which offers affordable studio accommodation, and three at our state-of-the-art TBY2 facility (pg 19) which offers premium, fully soundproofed stage space.

Stage spaces of up to 22,000 sq ft and heights of up to 34ft translate into endless opportunities for set builds. With a 5,000 sq ft green screen studio, 35,000 sq ft of furnished production offices and ample ancillary workspaces and parking - plus more than 20 on-site companies delivering specialist industry services - we've got everything required for a fully production base.

Drama, entertainment, comedy, children's, commercials, rehearsal space or live transmission.

**Our space, your creativity.  
It's all here.**





Find us in

**BRISTOL**



a UNESCO Creative City

GLOBAL  
PRODUCTION  
AWARDS 2024  
SCREEN

**WINNER**

CELEBRATING SUSTAINABLE  
GLOBAL PRODUCTION

**CITY OF FILM AWARD**  
BRISTOL, UK

The Bottle Yard Studios are located five miles south of Bristol city centre, you can reach us from London in under two hours. Just seven miles from Bristol Airport, direct flights are available from across the UK and Europe and international cities including New York and Los Angeles are easily linked via hub airports of Amsterdam, Paris Charles de Gaulle and Brussels.

We're proud to be located in one of the most film-friendly cities in the world. In 2017 Bristol was designated a UNESCO City of Film and in 2023 it brought home the international City of Film title at the 2023 Global Production Awards. Bristol & Bath was named one of seven UK Production Hubs by the British Film Commission in 2021 due to the depth of its filming eco-system, including its regional crew base and supply chain.

## WITHIN BRISTOL

You'll find a wealth of filming locations including grand Regency and Georgian terraces, expansive green spaces and gritty urban settings. Our colleagues at Bristol Film Office are on hand to make sure your shoot runs smoothly; sourcing locations to match your needs, escorting scouts on recces, arranging unit bases and processing filming permissions.

The Studios sit at the gateway to the West Country, one of the most versatile regions for filming in the country. Basing at The Bottle Yard gives easy access to the varied landscapes and historic houses of Bath and North East Somerset, South Gloucestershire, the Cotswolds and Wiltshire all within a 45 minute drive, and the breath-taking countryside and coastlines of Cornwall, Devon, Dorset and Somerset further afield.



*Rivals (Disney+)*  
Location: Corn Street, Bristol



*Down Cemetery Road (Apple TV+)*  
Location: St Werburgh's, Bristol



*Boarders (BBC Three)*  
Location: Clifton, Bristol



*The Crow Girl (Paramount+)*  
Location: Central Bristol

Rivals © Disney+

Down Cemetery Road © Apple TV+

Boarders © BBC

The Crow Girl © Paramount+



## OUR TWO STUDIO SITES



TBY2

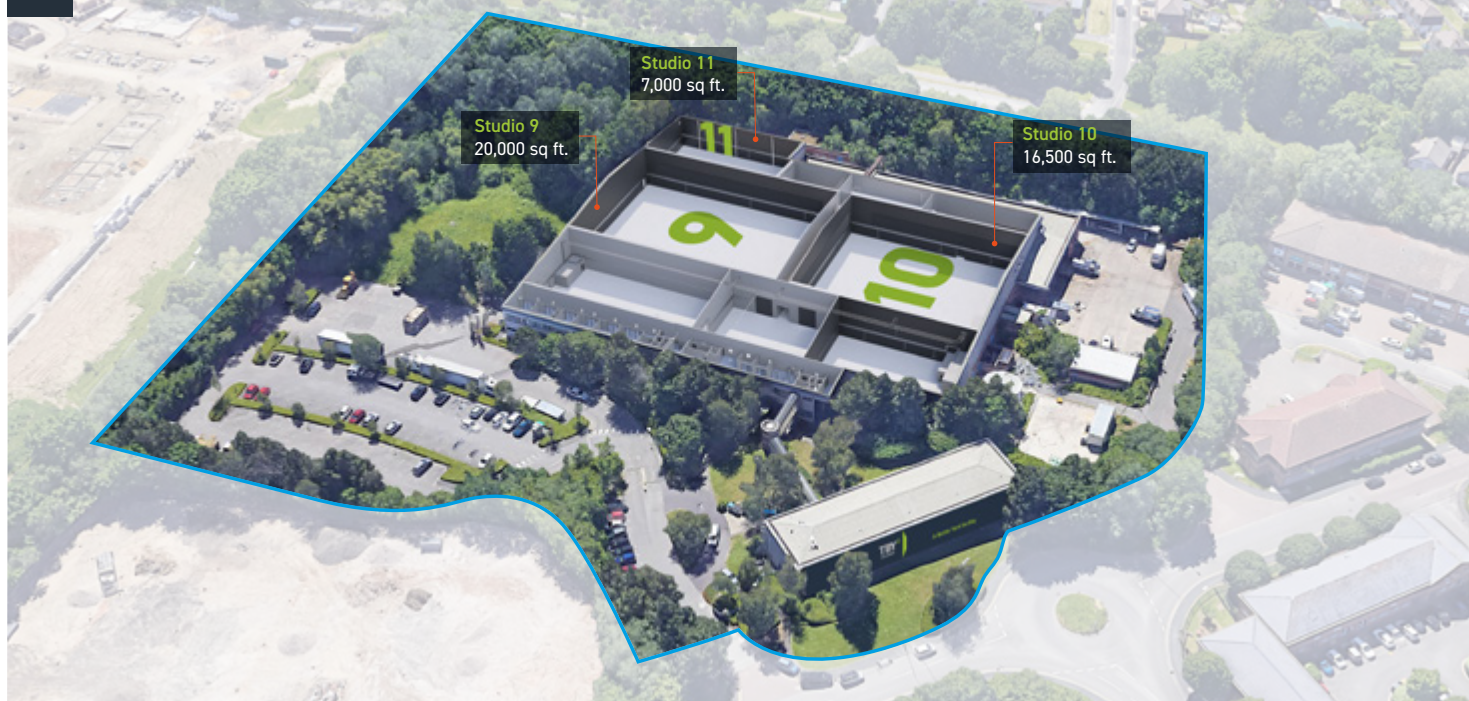

TBY1





## WE UNDERSTAND PRODUCTION

We are a team of problem solvers who have worked in TV production ourselves, so we know the type of service you need and the pressures you're under during demanding prep and shoot schedules.

It's our job to deliver the optimum filming environment during your time at The Bottle Yard, and our teammates at Bristol Film Office are on hand to provide bespoke location assistance if you're filming in the city.



Down Cemetery Road © Apple TV+



Rivals © Disney+



The Forsytes © PBS/5



A Good Girl's Guide to Murder © BBC/Netflix

"From our very first conversation it was clear how active and passionate they are about the community and how aligned we were. Their ethos is more than a sales pitch, it is built into the foundations of the Studio and business. From power and energy to crew, local suppliers and locations support through Bristol Film Office and skills development through All Set West; the Bottle Yard are supportive and progressive. Over the 12 months we were based out of TB2, they worked closely with us to optimise any and all opportunities to move the dial and create examples of positive action of what can be done by Studios."

**Karl Liegis, Head of Production**  
*60Forty Films (Down Cemetery Road)*

"Bristol and The Bottle Yard Studios were the perfect production base for Jilly Cooper's *Rivals*. We were excited to be the first production to use the two main stages of TB2 and they certainly lived up to our expectations. We were able to build the TV studio, complete with a 1980's control room, on one of the stages and used the second for other interiors and smaller sets that were needed across the series. We had our production and art department offices on site and the staff were on hand to help with all our requirements. We were able to find all our locations within a 30-mile radius, and one of the big attractions of filming in the Bristol area is that there are so many local crew of a very high calibre to choose from."

**Eliza Mellor, Producer**  
*Happy Prince (Rivals, Disney+)*

"The Bottle Yard Studios are a home from home for Mammoth Screen, many of our productions filming and returning for more over the last decade. Katherine, Emma and the entire team go above and beyond, ensuring we feel welcome and our teams are fully supported for the duration. The studios are versatile, affordable and sustainable, within easy reach of some remarkable locations in Bristol which are very well supported by the Film Office. Bristol is also a hub par excellence of a talented crew. We can't wait to return."

**Ronnie Castillo, Head of Production**  
*Mammoth Screen (The Forsytes, 5/ Masterpiece)*

"It was our genuine pleasure to return to The Bottle Yard for another Moonage Pictures show. From the undeniably talented local crews to the fantastic facilities at the Studios, Bristol was the perfect home. The Bottle Yard's location meant we could easily access rural landscapes for our chocolate box village and brooding woodland, which is home to Pip, her friends, and the deceptively dark and twisted world of the drama."

**Frith Tiplady, Executive Producer**  
*Moonage Pictures (A Good Girl's Guide to Murder, BBC/Netflix)*

Our space, your creativity. **It's all here.**



1

THE FRANCOMBE STAGE  
TANK HOUSE**Floor Area:**

Approx. 12,400 sq ft (1,150 sq m)

**Height:**

Approx. 27 ft (9 m)

**Power:**

x1 125 amp 3 phase  
13 amp available

**Water:**

No

**Scenic Access:**

H: 13 ft 6 (4.1 m) x W: 9 ft 5 (2.9 m)

112 ft (34 m)

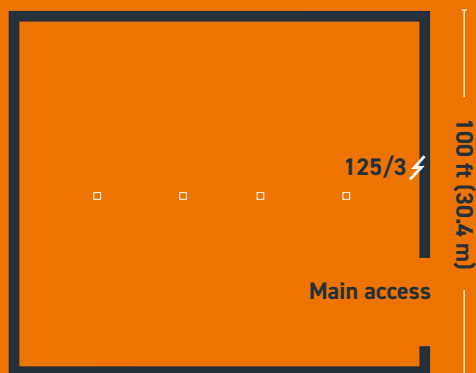



2

## TANK HOUSE

**Floor Area:**

Approx. 17,087 sq ft (1,587 sq m)

**Height:**

Approx. 27 ft (9 m)

**Power:**

x3 125 amp 3 phase  
 x3 16 amp single phase  
 13 amp available

**Water:**

Yes

**Scenic Access:**

H: 13 ft 7 (4.2 m) x W: 10 ft 3 (3.1 m)

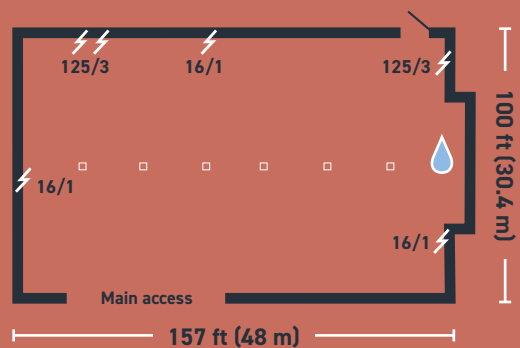



3

## TANK HOUSE

**Floor Area:**

Approx. 7,110 sq ft (660 sq m)

**Height:**

Approx. 65 ft (20 m)

**Power:**

x3 125 amp 3 phase (external)  
x1 63 amp 3 phase

**Water:**

Yes

**Scenic Access:**

H: 9 ft 8 (3 m) x W: 9 ft 8 (3 m)

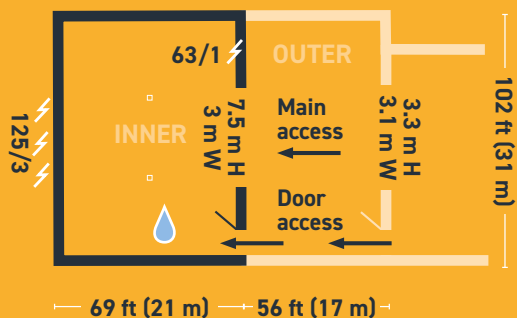



4

## TANK HOUSE

**Floor Area:**

Approx. 21,700 sq ft (2,020 sq m)

**Height:**

Approx. 24 ft (8 m)

**Power:**

x2 400 amp 3 phase

x1 125 amp 3 phase

x1 32 amp 3 phase

**Water:**

Yes

**Scenic Access:**

H: 13 ft 7 (4.4 m) x W: 10 ft 3 (3.7 m)

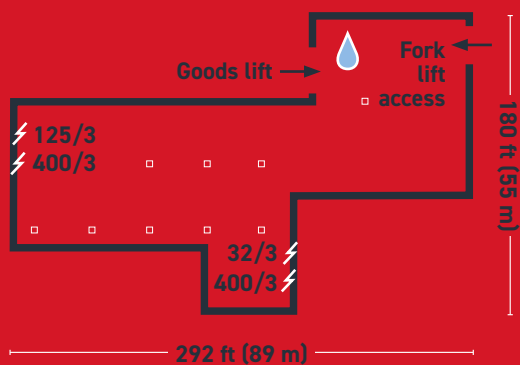



5

## EXPORT WAREHOUSE

**Floor Area:**

Approx. 15,945 sq ft (1,480 sq m)

**Height:**

Approx. 27 ft (9 m)

**Power:**x2 125 amp 3 phase  
13 amp available**Water:**

No

**Scenic Access:**

H: 14 ft 4 (4.4 m) x W 8 ft 8 (2.7 m)

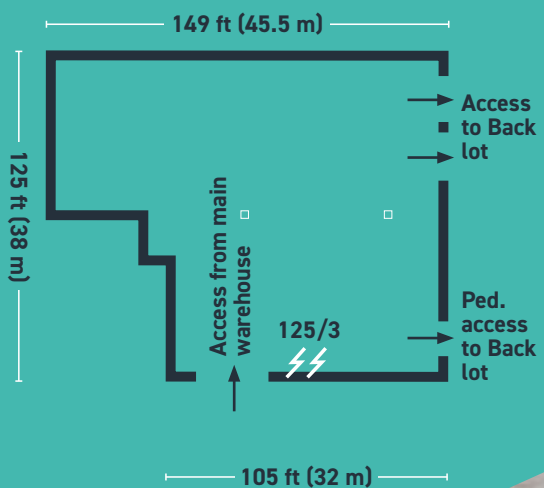
Enquiries: +44 (0)117 357 6888 / [thebottleyard@bristol.gov.uk](mailto:thebottleyard@bristol.gov.uk)Our space, your creativity. **It's all here.**



6

STUDIO

**Floor Area:**

Approx. 8,048 sq ft  
(747 sq m)

**Height:**

Approx. 27 ft / 8.5 m

**Power:**

x1 400 amp 3 phase  
x2 32 amp 3 phase  
x4 16 amp single phase  
13 amp available

**Water:**

No

**Scenic Access:**

H: 11 ft (3.3 m) x W: 10 ft 8 (3.3 m)

**Other Features:**

Optional production gallery; individual lighting and sound control rooms

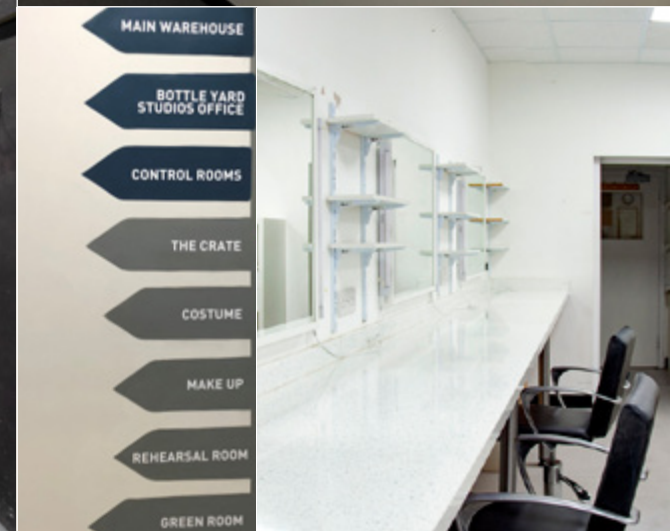
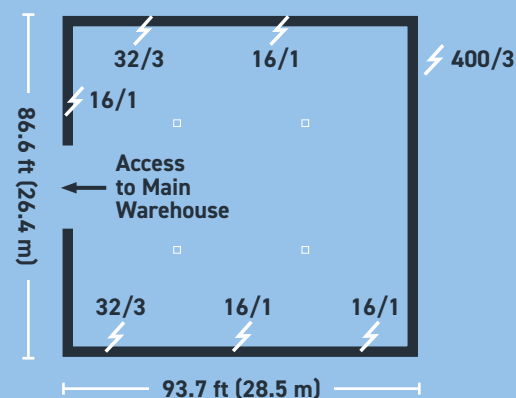



7

STUDIO

**Floor Area:**

Approx. 18,352 sq ft  
(1,705 sq m)

**Height:**

Approx. 27 ft (8.5 m)

**Power:**

x2 125 amp 3 phase  
13 amp available

**Water:**

No

**Scenic Access:**

H: 13 ft 6 (4.3 m) x W: 9 ft 5 (3.5 m)

**Other Features:**

Immediate access to Back Lot and  
unit base parking

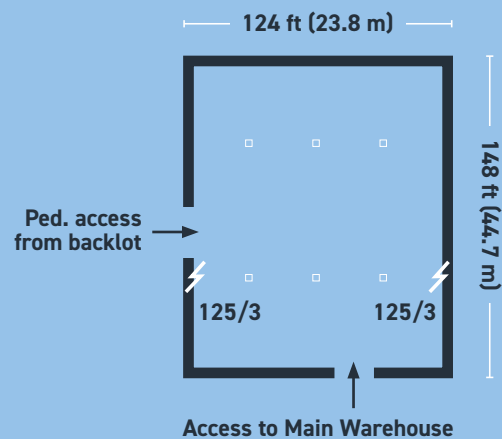





8

STUDIO  
GREEN SCREEN

### Floor Area:

Approx. 9,450 sq ft  
(878 sq m)

### Height:

Approx. 27 ft (8.5 m)

### Power:

x2 125 amp 3 phase  
x1 32 amp single phase

### Water:

No

### Scenic Access:

H: 15 ft (4.3 m) x W: 11ft 3 (3.5 m)

### Other Features:

5,000 sq ft green screen studio  
with infinity coving and green  
floor (can be removed if required)

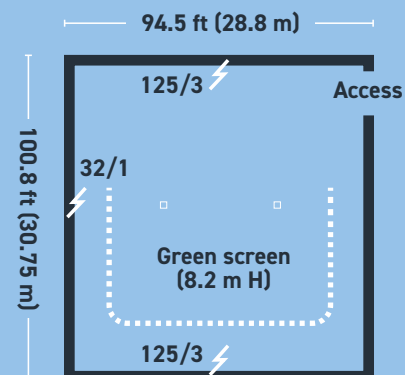



# PRODUCTION OFFICES

35,000 sq ft of furnished office space is available across our two sites TBY1 and TBY2, giving ample space to accommodate multiple production teams shooting on our stages or on location in the region at any time.

## OFFICE PACKAGES

- Flexible office suites to accommodate production and art department needs for productions of all sizes
- Rental rates inclusive of furnished offices, electricity usage, secure IT, weekly cleaning, domestic waste removal, dedicated HOD parking and access to inclusive welfare facilities



## CONNECTIVITY

- Up to 10GB resilient connectivity site-wide across our secure and supported network.
- Range of sophisticated IT systems and bespoke support packages available, including VoIP telephony, large upload capability, pay as you go bandwidth 'burst' options and bespoke network builds.





Our Production Village offers contained rooms for costume, make up, dressing and break out areas.



Elsewhere on site we offer plenty of construction space, workshops, prop and set storage options.



Our audience entrance provides a dedicated arrival point for audiences and contestants.



We know things get busy. Our Welfare Cabin gives crew the perfect space to take five and breathe...



Missed lunch? Reel Café is open every weekday from 8am-5pm offering a range of hot and cold refreshments.



## AMPLE PARKING

TBY1 offers 210 secure car parking spaces spread across 2.7 acres of hardstanding, which is also often used for exterior builds and unit base parking. TBY2 offers 160 secure parking spaces and dedicated unit base parking.

## ACCESSIBILITY



The Bottle Yard Studios is a TAP (TV Access Project) Activator. Our team has adopted the TAP Activator Commitments, which include embedding access for Deaf, Disabled and/or Neurodivergent talent across production spaces, prioritising disability training, and ensuring regular reviews of accessibility policies. Our two designated TAP Leads (one at each site) coordinate our ongoing efforts to proactively ensure accessibility across all areas of the business.

In November 2025 we successfully completed the TAP Production Building Access Description Checklist for both TBY1 and TBY2 sites, meaning that The Bottle Yard Studios is now officially TAP-certified as fit for inclusivity.



# BACK LOT

Measuring a total area of 60,000 sq ft, our extensive back lot has plenty of space to accommodate your additional parking needs as well as all kinds of major exterior set builds.

We've seen it transformed into street scenes, village centres, period facades and medieval forts.

What will **you** create?

*Sanditon - Regency street exterior, 70m long x 10m tall, built in The Bottle Yard backlot*  
© ITV

## SECURITY

With recently upgraded site wide CCTV, access control, ANPR systems, private roadways and 24/7 site security guards, we can ensure maximum privacy for your cast and crew, round the clock.



# The Distillery

at



The Bottle Yard Studios is pleased to present The Distillery, our flexible on-site filming location, available for short to medium term let now.

This spacious 1960's office block and commercial canteen is located at our original TBY1 site. Offering a versatile filming space, **it is available to style and dress in whichever manner your script requires.**



## Featuring:

- Main block containing approx. 50,000 sq ft of vacant offices, meeting rooms and stairwells spread across four floors.
- Separate two-storey canteen building containing approx. 11,500 sq ft of vacant space including an industrial kitchen, open plan dining hall and ground floor meeting rooms.
- Private roadways and avenues offering multiple directions and perspectives for exterior shoots.

**The Distillery can provide the perfect location for a wide range of exterior and interior settings, including hospitals, police stations, schools, libraries and more.**

**Booking The Distillery unlocks access to the broad range of benefits available to Studio clientele, including:**

- Private location access within a secure studio environment
- Ample on-plot parking, capable of accommodating large units
- 24/7 site security
- Support from our Studio Management Team
- Access to our Creative Hub of businesses delivering industry-related services including creative, digital, technical and audio/visual expertise, grips, transport, structural and safety assistance.

**For more information, contact us today on +44(0)117 357 6888 or [thebottleyard@bristol.gov.uk](mailto:thebottleyard@bristol.gov.uk)**





Our Creative Hub has 18 businesses and organisations permanently based on site, providing a range of film and TV services

**Services include:** broadcast equipment hire / café / camera rental / casting / chauffeur services / costume hire / education & skills provision / grips / IT support / lighting / location safety / post production / rigging / security services / set construction / transport / VFX



Figure 9



Sid Wild  
Films Ltd.





# TBY<sup>2</sup> STUDIOS

A Bottle Yard facility



Premium studio space at The Bottle Yard's second site



# TBY<sup>2</sup> STUDIOS

A Bottle Yard facility

Welcome to TBY2, The Bottle Yard Studio's award-winning second facility, which opened in 2022 offering three BAFTA albert-accredited premium quality sound stages.

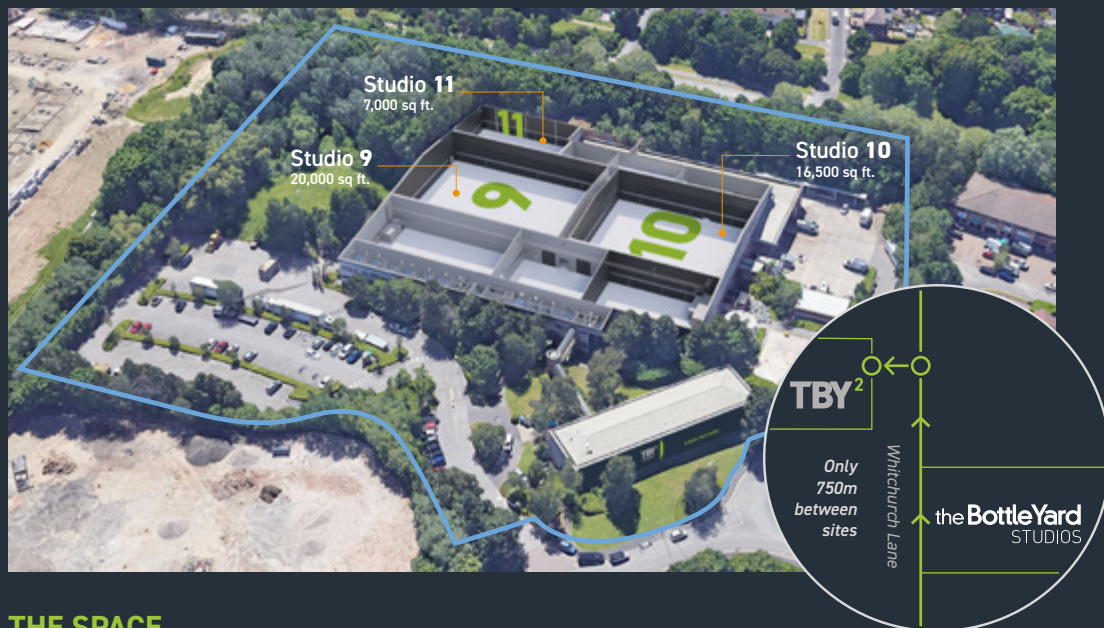

## THE SPACE

Less than half a mile from the original Bottle Yard site, the £12 million state-of-the-art TBY2 facility features:

- Three sound stages measuring 20,000 sq ft, 16,500 sq ft and 7,000 sq ft
- Power supply supported by a gigantic 1MWp solar array, the biggest community-owned PV rooftop in the UK
- Clear span space offering uninterrupted potential for set builds
- Fully sound insulated, acoustically treated stages
- Ceiling heights of up to 34 ft
- Ventilation, heating and cooling in stages
- Over 40,000 sq ft of ancillary space including serviced production offices, prop stores, construction workshops, costume/makeup and break out areas
- Dedicated unit base parking
- 160 car parking spaces



## Studio 9:

As well as being the biggest of the TBY2 stages, Studio 9 is the largest clear span studio in the South West. Offering 20,000 sq ft of fully soundproofed, uninterrupted floor space, with 34 ft ceiling height, it is a flexible stage capable of accommodating large scale film and high end TV productions.

## Build Space:

Approx. 20,048 sq ft (1,862 sq m)  
Height approx. 34 ft (10.3m) to truss

## Power:

2 x 400 amp 3 phase / 1 x 125 amp 3 phase (dimmer room)  
16 amp, 13 amp & 32 amp 3 phase around stage perimeter

## Scenic Access:

Height 16 ft (5m) x Width 13 ft (4m)

## Sound:

Exceptionally high levels of sound insulation applied to walls and roof, protecting stage from noise ingress.

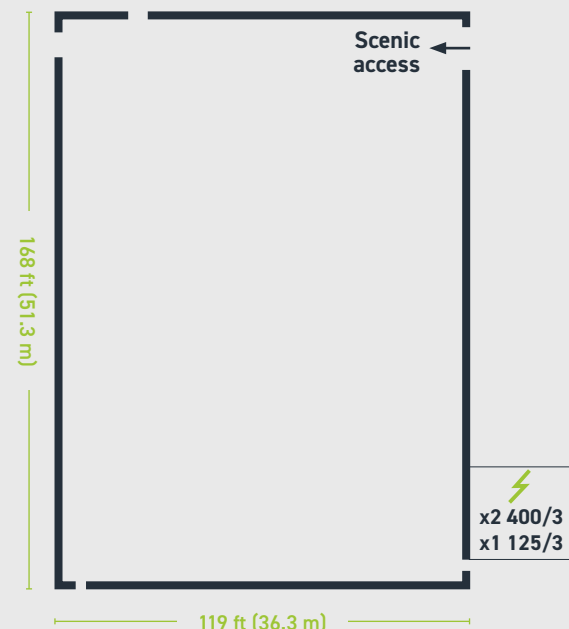

Our space, your creativity. It's all here.



## Studio 10:

The second-largest build space at TBY2, Studio 10 has 16,500 sq ft of premium sound stage accommodation with ceiling heights of 34 ft. With built-in heating, cooling and ventilation, all three TBY2 stages offer a comfortable, turn key solution suitable for any type of production.

### Build Space:

Approx. 16,541 sq ft (1,539 sq m)  
Height approx. 34 ft (10.3m) to truss

### Power:

2 x 400 amp 3 phase / 1 x 125 amp 3 phase (dimmer room)

16 amp, 13 amp & 32 amp 3 phase around stage perimeter

### Scenic Access:

Height 16 ft (5m) x Width 13 ft (4m)

### Sound:

Exceptionally high levels of sound insulation applied to walls and roof, protecting stage from noise ingress.

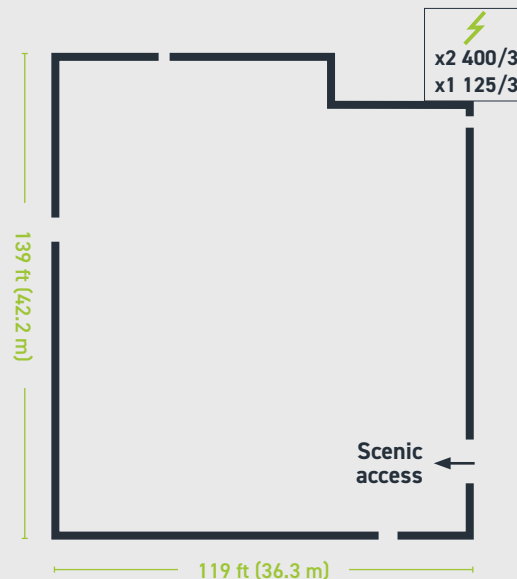

## Studio 11:

Studio 11 offers 7,000 sq ft of clear span space with heights of 30 ft. It's the perfect space for a medium-scale set build, or your next virtual production or green screen project.

### Build Space:

Approx. 7,013 sq ft (652 sq m)  
Height approx. 30 ft (9m) to truss

### Power:

1 x 400 amp 3 phase / 1 x 125 3 phase (dimmer room)

16 amp, 13 amp & 32 amp 3 phase around stage perimeter

### Scenic Access:

Height 13 ft (4m) x Width 10 ft (3m)

### Sound:

Exceptionally high levels of sound insulation applied to walls and roof, protecting stage from noise ingress.

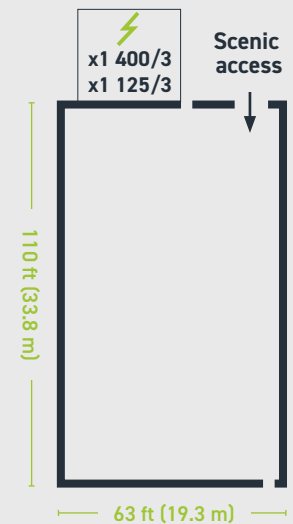





Vehicle access to Studios 9 and 10



Construction space

## THE BENEFITS

Basing at TBY2 means you'll enjoy the same benefits available at our original site TBY1, including:

- Dedicated support from our experienced Studio Management team
- 24/7 site security
- Up to 10GB resilient and secure connectivity
- On-site IT engineer support
- Access to our Creative Hub of businesses

## THE SUSTAINABLE BUILD

TBY2 was the highest performing studio in the BAFTA albert 2025-26 global Studio Sustainability Standard, achieving 'Outstanding' alongside TBY1's 'Excellent' rating.

The facility was designed and built with premium insulation in mind and boasts a sophisticated building management system that optimises energy conservation at all times.

TBY2's power supply is supported by a giant 1MW solar array, one of the largest community-owned PV rooftops in the UK. The ambitious installation won Best Sustainable Initiative at the 2023 Global Production Awards.

Electric vehicle points and cycling facilities support carbon neutral travel between TBY2 and TBY1.

**#wearebottleyardGREEN**

## THE OPPORTUNITY

**Contact us now to book TBY2 for your next film or high-end TV production.**

### Enquiries:

**+44 (0)117 357 6888 / thebottleyard@bristol.gov.uk**

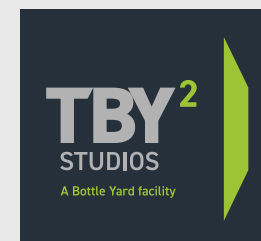

**Enquiries: +44 (0)117 357 6888 / thebottleyard@bristol.gov.uk**

**Our space, your creativity. It's all here.**



# AWARD-WINNING SUSTAINABILITY

## BAFTA ALBERT ACCREDITED

Both of our sites are fully BAFTA albert-accredited. Not only that, TBY2 was the highest performing studio in the 2025/26 BAFTA albert Studio Sustainability Standard, scoring higher than 30 other studios around the globe. TBY2 achieved an Outstanding rating alongside TBY1's Excellent rating.

TBY2 rating:



2025/26  
Studio Sustainability  
Standard  
**Outstanding**

TBY1 rating:



2025/26  
Studio Sustainability  
Standard  
**Excellent**

Our roots lie in repurposing. At TBY1, we created continued use for a bottling factory site the size of three football pitches, and our expansion at TBY2 has breathed new life into an industrial gear factory.

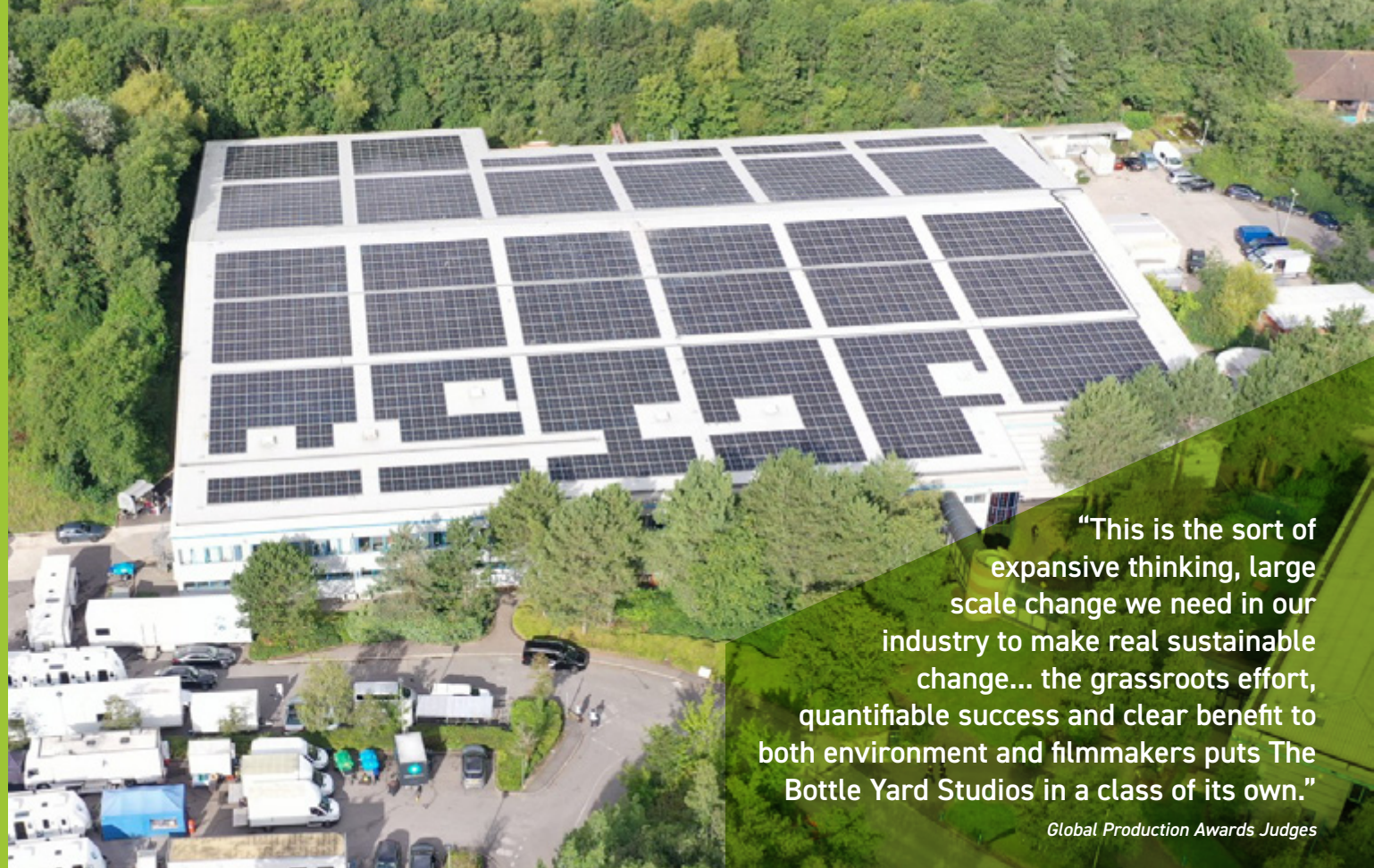

"This is the sort of expansive thinking, large scale change we need in our industry to make real sustainable change... the grassroots effort, quantifiable success and clear benefit to both environment and filmmakers puts The Bottle Yard Studios in a class of its own."

*Global Production Awards Judges*

## BIG ON SOLAR

With 2,380 panels, TBY2's award-winning 1MWp solar array is the UK's biggest community-owned PV rooftop. It produces enough energy to run 250 homes annually and saves 200 tonnes of CO<sub>2</sub> per year.

Funded by Bristol Energy Cooperative, the array is not just generating power for TBY2, it's also helping Bristol reach its 2030 net zero target. Surplus energy is sleeved to other city buildings via Bristol's groundbreaking City Leap network.

Our Green Team is committed to reducing the carbon output generated by filming at the Studios and on location in Bristol.

## ASK US ABOUT:

- EV charging points
- Our client-facing sustainability toolkit
- Our local sustainable suppliers list
- Electric unit base supplies
- Bespoke waste solution packages
- Set/electricals repurposing and
- On-site recycling stations
- Communal refill stations
- Sustainable set striking
- Our Carbon Literacy reps
- Set/electricals repurposing
- Battery/print cartridge collection
- Low carbon heating solutions
- Local public transport and cycling routes
- Upcoming sustainability events





**Our space,  
your creativity.  
It's all here.**

### **Get in touch**

+44 (0)117 357 6888 [thebottleyard@bristol.gov.uk](mailto:thebottleyard@bristol.gov.uk)

**The Bottle Yard Studios**  
Whitchurch Lane,  
Bristol, BS14 0BH

**TBY2**  
Hawkfield Way,  
Bristol, BS14 0BD

[thebottleyard.com](http://thebottleyard.com)



[@TheBottleYard](https://www.facebook.com/TheBottleYard)



[@TheBottleYardStudios](https://www.instagram.com/TheBottleYardStudios)



[thebottleyard](https://www.linkedin.com/company/thebottleyard)



**WEST** MAYORAL  
OF ENGLAND COMBINED  
AUTHORITY

